

## Product Datasheet

# 10-Port 10/100Mbps Non-standard PoE Switch

## ONV-H2108PL



## OVERVIEW

The ONV-H2108PL series is a non-standard PoE switch independently developed by ONV. It has 8\* 10/100M PoE ports and 2\*10/100M uplink RJ45 ports. Port 1-8 can support 24V non-standard PoE power supply, single-port PoE power up to 30W. total power is 120W. As a non-standard PoE power supply device, it must be connected to the corresponding non-standard electrical equipment (such as a wireless bridge), or the corresponding non-standard separation line to convert, and then achieve the PoE power supply. It can supply power to various adaptable terminals through network cables to meet the demand for high density PoE power supply network environment. It is suitable for hotels, campuses, factory dormitories, and small and medium-sized enterprises to establish cost-effective networks.

Unmanaged model, plug and play, no configuration, easy to use.

## FEATURE

### ■ 10/100Mbps access, Dual RJ45 ports

- ◇ Provides 8\*10/100M RJ45 ports and 2\*10/100M RJ45 ports, which is more convenient for users to flexibly set up to meet the network requirements of various scenarios.
- ◇ Support non-blocking wire-speed forwarding.
- ◇ Support full-duplex based on IEEE802.3x and half-duplex based on backpressure.

### ■ Intelligent PoE power supply function

- ◇ 8\*10/100Base-TX RJ45 ports can support 24V PoE power supply meeting the needs of security monitoring, teleconferencing system, wireless coverage, and other scenarios.
- ◇ The maximum PoE output power is 120W, and the maximum PoE output power of single port is 30W.
- ◇ It can quickly realize the power supply function of POE cable through the two ways of switching directly to non-standard electrical equipment or switch and non-standard separation line.

### ■ Easy to use

- ◇ Plug and play, no configuration, simple and convenient.
- ◇ The user-friendly panel, it can show the device status through the LED indicator of Power, L/A.
- ◇ With function switch, port 1-8 can support 10M/250m long-distance transmission and video surveillance mode when turned on.

### ■ Stable and reliable

- ◇ CCC,CE, FCC, RoHS.
- ◇ Low power consumption, galvanized steel casing,no fan.
- ◇ Self-developed power supply, high redundancy design, providing a long term and stable PoE power output.

## TECHNICAL SPECIFICATION

Model	ONV-H2064PL	ONV-H2108PL
<b>Interface Characteristics</b>		
Fixed Port	4*10/100Base-TX PoE ports (Data/Power)  2*10/100Base-TX uplink RJ45 Ports (Data)	8*10/100Base-TX PoE ports (Data/Power)  2*10/100Base-TX uplink RJ45 Ports (Data)
Ethernet Port	10/100Base-T(X) auto-sensing, full/half duplex MDI/MDI-X self-adaption	
Functional Switch (Extender)	After opening, port 1-4 can support 10M/250m long distance transmission and CCTV	After opening, port 1-8 can support 10M/250m long distance transmission and CCTV
	<b>Note:</b> When the switch status changes, the PoE switch must be restarted for the switch function to take effect.	
Twisted Pair Transmission	10BASE-TX : Cat5 or later UTP(≤250 meter) 100BASE-TX: Cat5 or later UTP(≤100 meter)	
<b>Chip Parameter</b>		
Network Protocol	IEEE802.3 10BASE-T, IEEE802.3i 10Base-T IEEE802.3u 100Base-TX, IEEE802.3ab 1000Base-T IEEE802.3x	
Forwarding Mode	Store and Forward(Full Wire Speed)	
Switching Capacity	1.6Gbps (Non-blocking)	2Gbps (Non-blocking)
Forwarding Rate@64byte	0.89Mpps	1.488Mpps
MAC	1K	2K
Buffer Memory	768K	1.25M
Jumbo Frame	10K	
LED Indicator	Power: PWR (green), network:L/A (green), function switch: EXTEND (green)	

<b>PoE &amp; Power</b>		
PoE Port	Port 1-4 can support 24V PoE power supply	Port 1-8 can support 24V PoE power supply
Power Supply Pin	Default 1/2 (+), 3/6 (-)	
Max Power Per Port	30W; IEEE802.3af/at	
Total PWR / Input Voltage	65W / (AC100-240V)	120W / (AC100-240V)
Power Consumption	Standby<3W, Full load<60W	Standby<5W, Full load<120W
Power Supply	Built-in power supply, AC100~240V 50-60Hz 1A	Built-in power supply, AC100~240V 50-60Hz 2.2A
<b>Physical Parameter</b>		
Operation TEMP / Humidity	-20~+55°C, 5%~90% RH Non condensing	
Storage TEMP / Humidity	-40~+75°C, 5%~95% RH Non condensing	
Dimension (L*W*H)	142*115*40mm	195*130*40mm
Net /Gross Weight	<0.6kg / <1kg	<0.8kg / <1.2kg
Installation	Desktop, wall mounted, rack mounted	
<b>Certification &amp; Warranty</b>		
Lightning protection / protection level	Lightning protection: 4KV 8/20us; Protection level: IP30	
Certification	CCC, CE mark, commercial; CE/LVD EN60950; FCC Part 15 Class B; RoHS	
Warranty	1 year, lifelong maintenance.	

## DIMENSION

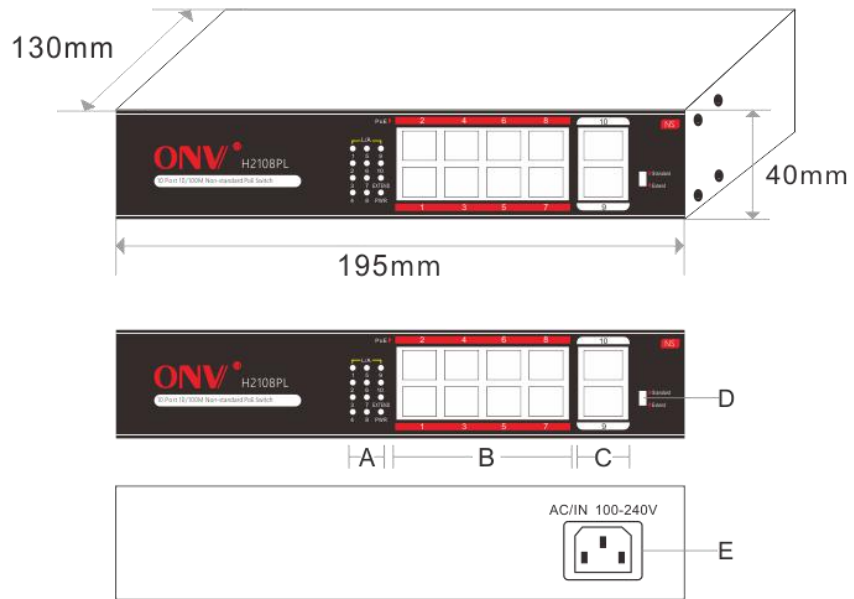

- A. Working LED Indicator
- B. 8\*10/100M Non-Standard PoE Ports
- C. 10/100M Uplink RJ45 Port
- D. Functional Switch
- E. Power Input Port - AC100-240V, 50/60HZ

## APPLICATION

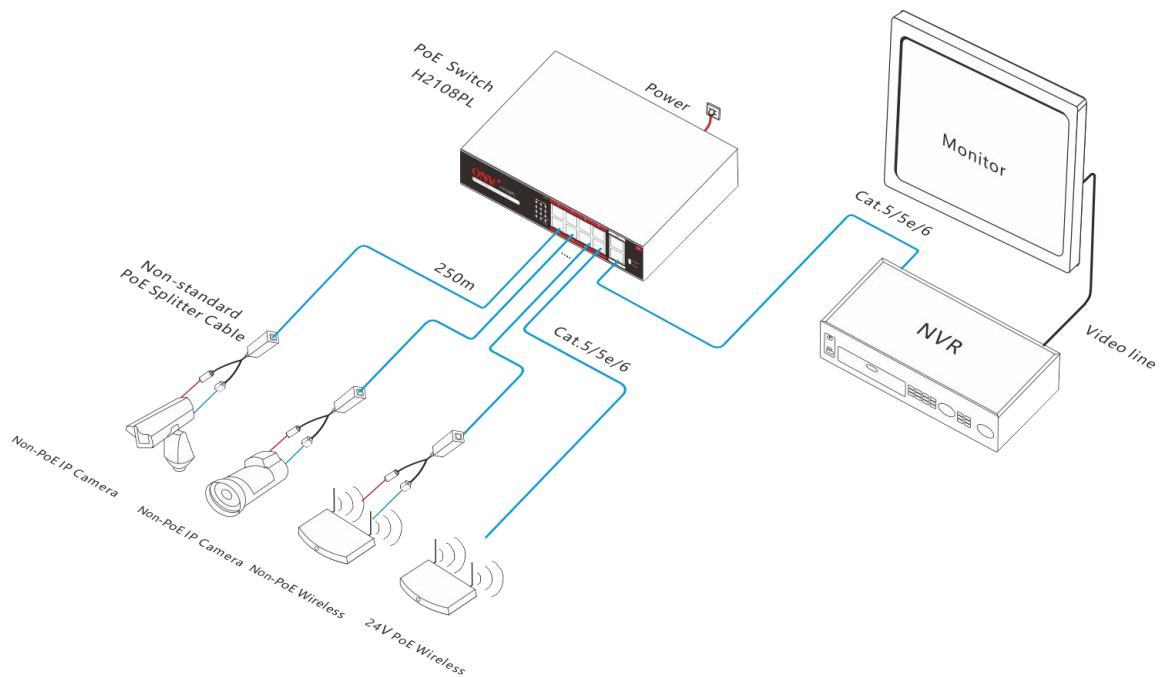

## ORDERING INFORMATION

Model	Description
ONV-H2064PL	Unmanaged PoE switch with 4*10/100M RJ45 ports and 2*10/100M uplink RJ45 ports. Port 1-4 support DC24V non-standard POE power supply, Adjust the function switch to realize 1-4 ports VLAN isolation and 10M/250m long distance transmission. Built-in 65W power supply.
ONV-H2108PL	Unmanaged PoE switch with 8*10/100M RJ45 ports and 2*10/100M uplink RJ45 ports. Port 1-8 support DC24V non-standard POE power supply, Adjust the function switch to realize 1-8 ports VLAN isolation and 10M/250m long distance transmission. Built-in 120W power supply.

**Note:** This series model does not support the mounting ear by default.

## PACKING LIST

	CONTENT	QTY	UNIT
PACKING LIST	10-Port 10/100Mbps non-standard PoE switch	1	SET
	AC Power Cable	1	PC
	Mounting Kits	1	SET
	User Guide	1	PC
	Warranty Card	1	PC

## CONTACT US



OPTICAL NETWORK VIDEO TECHNOLOGIES (SHENZHEN) CO., LTD

Tel: 0086-755-33376606

Fax: 0086-755-33376608

Email: [onv@onv.com.cn](mailto:onv@onv.com.cn)

Website: [www.onvcom.com](http://www.onvcom.com)

Zip: 518000

Headquarter Address: Room 1003, Block D, Terra Building, Futian District, Shenzhen, China

Factory Address: The 4-6th Floor, No. 59, HuaNing Road, Xinwei Community, Dalang Street,  
Longhua District, Shenzhen, China

