

# Product Datasheet

## 26-Port Gigabit Uplink Non-standard PoE Switch

ONV-H2024PL



### OVERVIEW

The ONV-H2024PL series is a non-standard PoE switch independently developed by ONV. It has 24\* 10/100M RJ45 ports and 2\*10/100/1000M uplink RJ45 ports. Port 1-24 can support 24V non-standard PoE power supply, single-port PoE power up to 30W. total power is 250W. As a non-standard PoE power supply device, it must be connected to the corresponding non-standard electrical equipment (such as a wireless bridge), or the corresponding non-standard separation line to convert, and then achieve the PoE power supply. It can supply power to various adaptable terminals through network cables to meet the demand for high density PoE power supply network environment. It is suitable for hotels, campuses, factory dormitories, and small and medium-sized enterprises to establish cost-effective networks.

Unmanaged model, plug and play, no configuration, easy to use.

## FEATURE

### ■ 10/100Mbps access, gigabit uplink

- ◇ Provides 24\*10/100M RJ45 ports and 2\*10/100/1000M RJ45 ports, which is more convenient for users to flexibly set up to meet the network requirements of various scenarios.
- ◇ Support non-blocking wire-speed forwarding.
- ◇ Support full-duplex based on IEEE802.3x and half-duplex based on backpressure.

### ■ Intelligent PoE power supply function

- ◇ 24\*10/100Base-TX RJ45 ports can support 24V PoE power supply meeting the needs of security monitoring, teleconferencing system, wireless coverage, and other scenarios.
- ◇ The maximum PoE output power is 250W, and the maximum PoE output power of single port is 30W.
- ◇ It can quickly realize the power supply function of POE cable through the two ways of switching directly to non-standard electrical equipment or switch and non-standard separation line.

### ■ Stable and reliable,easy to use

- ◇ CCC,CE, FCC, RoHS.
- ◇ Plug and play, no configuration, simple and convenient.
- ◇ Low power consumption, galvanized steel casing,no fan.
- ◇ Self-developed power supply, high redundancy design, providing a long term and stable PoE power output.
- ◇ The user-friendly panel, it can show the device status through the LED indicator of PWR, Link, PoE.

## TECHNICAL SPECIFICATION

Model	ONV-H2016PL	ONV-H2024PL
<b>Interface Characteristics</b>		
Fixed Port	16*10/100Base-TX PoE ports (Data/Power)	24*10/100Base-TX PoE ports (Data/Power)
	2*10/100/1000Base-T RJ45 Ports (Data)	2*10/100/1000Base-T RJ45 Ports (Data)
Ethernet Port	10/100Base-T(X) or 10/100/1000Base-T auto-sensing, full/half duplex MDI/MDI-X self-adaption	
Functional Switch (Extender)	After opening, port 9-16 can support 10M/250 meter long distance transmission.	After opening, port 17-24 can support 10M/250 meter long distance transmission.
	<b>Note:</b> When the switch status changes, the POE switch must be restarted for the switch function to take effect.	
Twisted Pair Transmission	10BASE-TX : Cat5 or later UTP(≤250 meter) 100BASE-TX: Cat5 or later UTP(≤100 meter) 1000BASE-T :Cat5e or later UTP(≤100 meter)	
<b>Chip Parameter</b>		
Network Protocol	IEEE802.3 10BASE-T, IEEE802.3i 10Base-T IEEE802.3u 100Base-TX, IEEE802.3ab 1000Base-T IEEE802.3x	
Forwarding Mode	Store and Forward(Full Wire Speed)	
Switching Capacity	14.8Gbps (Non-blocking)	
Forwarding Rate@64byte	5.36Mpps	6.55Mpps
MAC	16K	
Buffer Memory	4M	

Jumbo Frame	10K	
LED Indicator	Power: PWR (green), network: (green)	
<b>PoE &amp; Power</b>		
PoE Port	Port 1-16 can support 24V PoE power supply	Port 1-24 can support 24V PoE power supply
Power Supply Pin	Default 1/2 (+), 3/6 (-)	
Max Power Per Port	30W; IEEE802.3af/at	
Total PWR / Input Voltage	250W /(AC100-240V)	
Power Consumption	Standby<15W, Full Load<250W	Standby<20W, Full Load<250W
Power Supply	Built-in power supply, AC 100~240V 50-60Hz 4.1A	
<b>Physical Parameter</b>		
Operation TEMP / Humidity	-20~+55°C, 5%~90% RH Non condensing	
Storage TEMP / Humidity	-40~+75°C, 5%~95% RH Non condensing	
Dimension (L*W*H)	270*181*44.5mm	330*204*44mm
Net /Gross Weight	<1.7kg / <2.2kg	<3.0kg / <3.5kg
Installation	Desktop,wall mounted, rack mounted	
<b>Certification &amp; Warranty</b>		
Lightning protection / protection level	Lightning protection: 4KV 8/20us; Protection level: IP30	
Certification	CCC,CE mark, commercial; CE/LVD EN60950;FCC Part 15 Class B; RoHS	
Warranty	1 year, lifelong maintenance.	

## DIMENSION

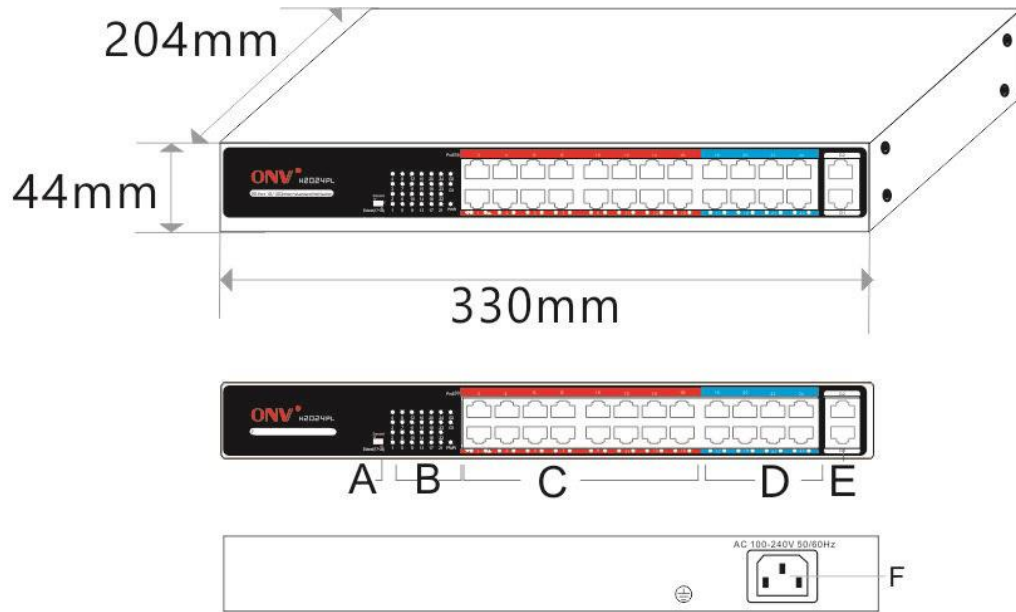

- A. Multi-function switch
- B. Working indicator
- C. 100 meters non-standard PoE ports
- D. 250 meters non-standard PoE ports
- E. 2\*10/100/1000M uplink RJ45 ports
- F. Power input port AC100-240V,50/60Hz

## APPLICATION

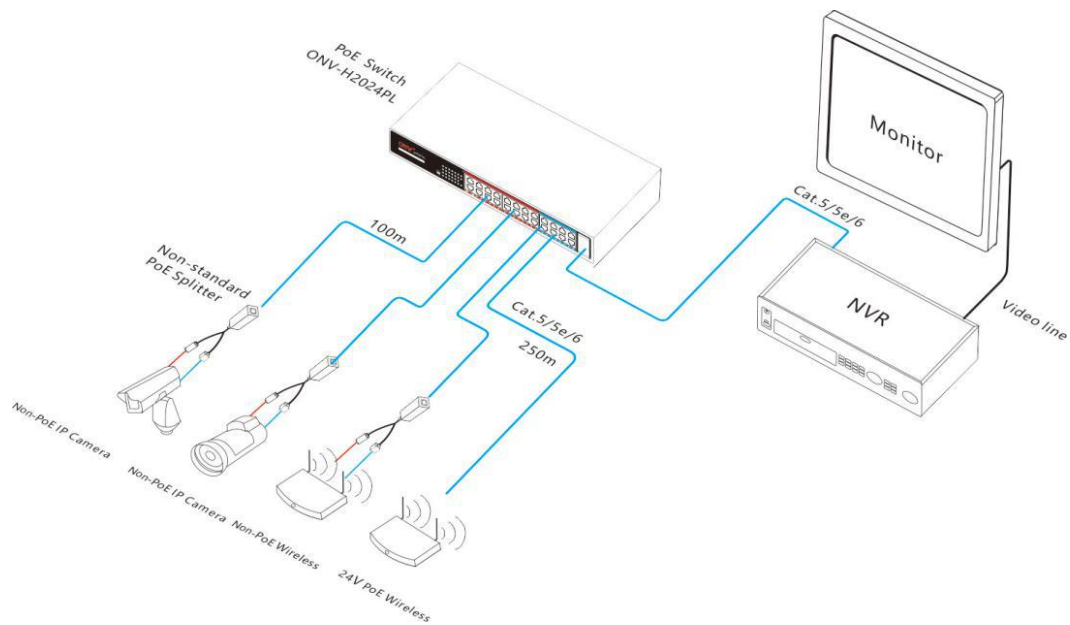

## ORDERING INFORMATION

Model	Description
ONV-H2016PL	Unmanaged PoE switch with 16*10/100M RJ45 ports and 2*10/100/1000M uplink RJ45 ports. Port 1-16 support 24V non-standard POE power supply, Port 9-16 can support 10M/250 meters long distance transmission. Built-in 250W power supply.
ONV-H2024PL	Unmanaged PoE switch with 24*10/100M RJ45 ports and 2*10/100/1000M uplink RJ45 ports. Port 1-24 support 24V non-standard POE power supply, Port 17-24 can support 10M/250 meters long distance transmission. Built-in 250W power supply .

## PACKING LIST

	CONTENT	QTY	UNIT
PACKING LIST	26-port gigabit uplink non-standard PoE switch	1	SET
	AC Power Cable	1	PC
	Mounting Kits	1	SET
	User Guide	1	PC
	Warranty Card	1	PC

## CONTACT US

**ONV** OPTICAL NETWORK VIDEO TECHNOLOGIES (SHENZHEN) CO., LTD

Tel: 0086-755-33376606

Fax: 0086-755-33376608

Email: [onv@onv.com.cn](mailto:onv@onv.com.cn)

Website: [www.onvcom.com](http://www.onvcom.com)

Zip: 518000

Headquarter Address: Room 1003, Block D, Terra Building, Futian District, Shenzhen, China

Factory Address: The 4-6th Floor, No. 59, HuaNing Road, Xinwei Community, Dalang Street,  
Longhua District, Shenzhen, China

